

REAR VIEW OF PROPELLER

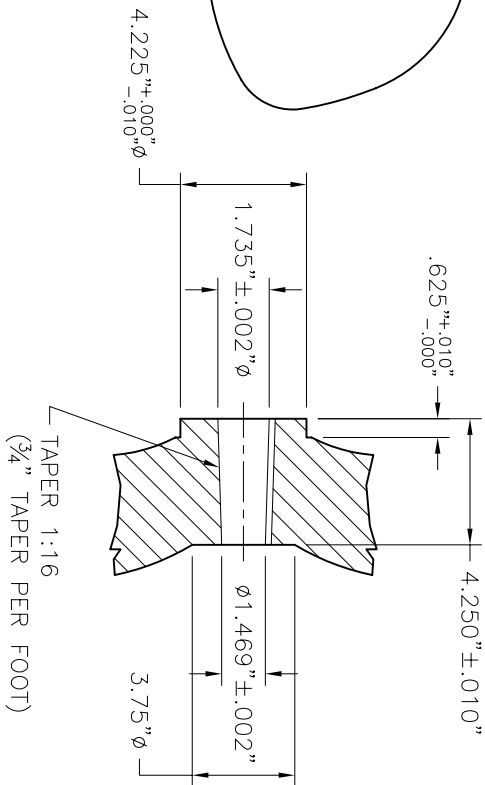

PROPELLER HUB CROSS SECTION

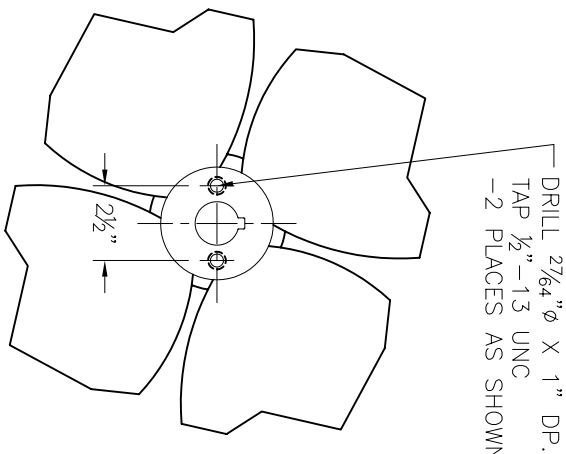

FRONT VIEW OF PROPELLER

THE INFORMATION CONTAINED IN THIS DRAWING IS THE SOLE PROPERTY OF OLYMPIC DRIVES & EQUIPMENT LTD. ANY REPRODUCTION IN PART OR WHOLE WITHOUT THE WRITTEN PERMISSION OF SUMMER EQUIPMENT IS PROHIBITED.

MODEL HD3 OLYMPIC Z-DRIVE
PROPELLER TAPER MACHINING DETAILS



OLYMPIC DRIVES & EQUIPMENT LTD.
UNIT 120, 6751 GRAYBAR RD., RICHMOND
BRITISH COLUMBIA, CANADA, V6W 1H3
PHONE (604)-207-8444 FAX (604)-207-8441
www.olympicdrives.com

MANUFACTURERS OF 360° AZIMUTHING THRUSTERS

DRAWN BY: P.D.W.

CHECKED BY: M.L.G.

SCALE: N.T.S.

DATE: MARCH, 2004

DRAWING NO.

REV.

REF NO:

B-0439